

REV.	ECN NO.	DESCRIPTION	DRAW	APPD.	DATE
A	---				

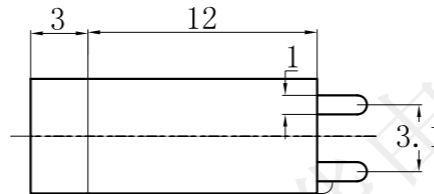

线路板开孔尺寸

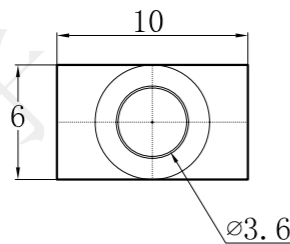
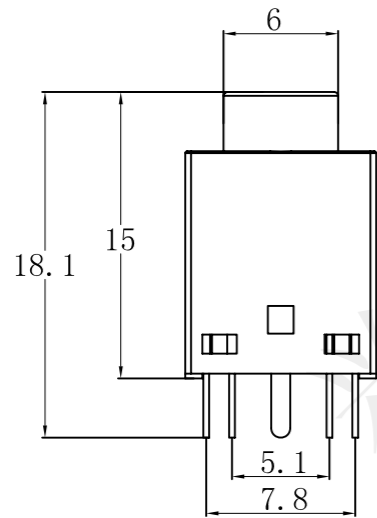
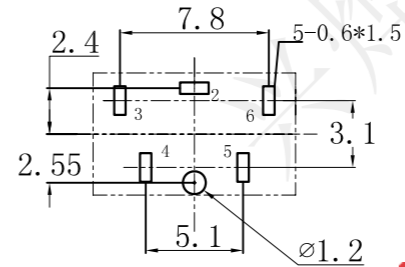

受控文件

SPECIFICATION:

Operating temperature: -30 °C~70 °C
 Rated loading: DC 30V 0.5A
 Contact resistance: 30mΩ Max
 Insulation resistance: 100MΩ Min
 Withstanding voltage: AC 500V (50Hz) /min
 Insertion force: 3-20N
 Pullout force: 3-20N
 Life: 5000 CYCLES

6	基座	1	PBT	黑/配色
5	6#接触脚	1	QSn6.5-0.1锡青铜带 $\delta=0.250\text{mm}$	
4	5#接触脚	1	H62 (Y) 黄铜带 $\delta=0.30\text{mm}$	
3	4#接触脚	1	H62 (Y) 黄铜带 $\delta=0.30\text{mm}$	
2	3#接触脚	1	QSn6.5-0.1锡青铜带 $\delta=0.250\text{mm}$	
1	2#接触脚	1	QSn6.5-0.1锡青铜带 $\delta=0.30\text{mm}$	
序号	名称	数量	材料	备注

电路原理图

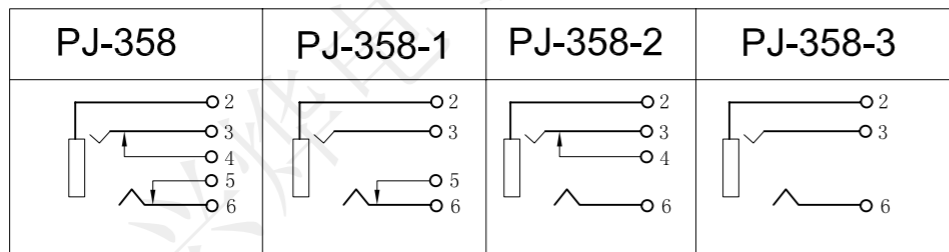

深圳市兴烨电子有限公司
 Shenzhen XingYe Electronics Co., Ltd

TOLERANCE		APPD: 陈爱光
X.X ±0.30	X.° ±2°	CHEd: 施立敏
.XX ±0.20	.X.° ±1°	DRAW: 马洪飞
.XXX ±0.10	.XX.° ±0.5°	
UNITS	mm	

Series Name :		
Product Name : PJ-358-5P直插		
Part NO: PJL11031		
SCALE	SHEET	REV.
1:1	1/1	A1