

REV.	ECN NO.	DESCRIPTION	DRAW	APPD.	DATE
A	---				

3 POLE

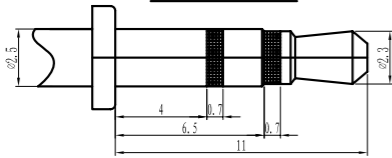

4 POLE

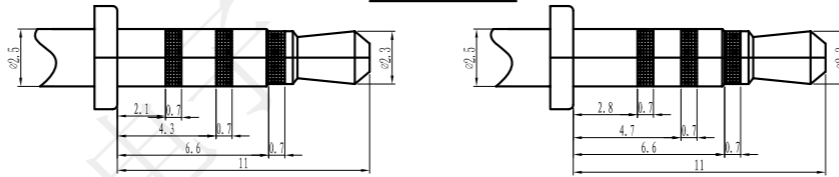

Recommended Plug

SPECIFICATION

1. Rating : DC 30V 0.5A;
2. Contact resistance: $\leq 0.03 \Omega$;
3. Insulation resistance: $\geq 100M \Omega$ (DC250V);
4. Withstand voltage: 500VAC ;
5. Insertion and extraction force : 3-20N;
6. life test: 5,000 cycles.

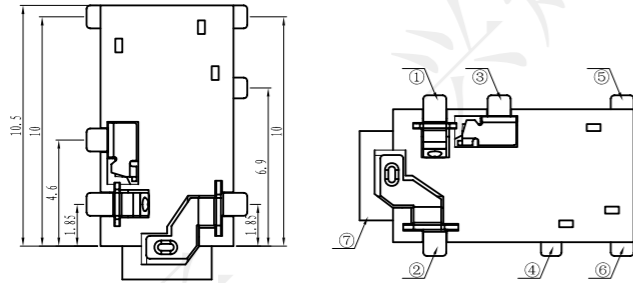

P. C. B LAYOUT TOP VIEW

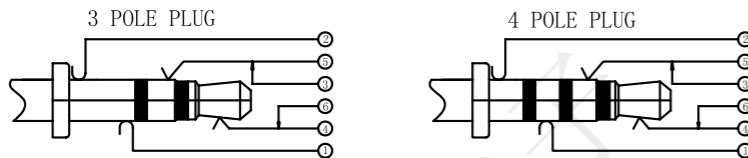
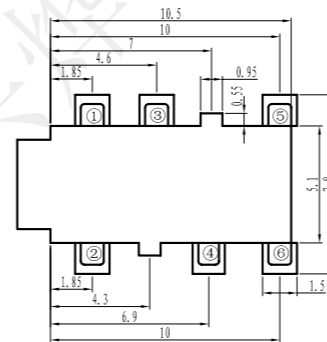
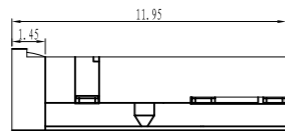
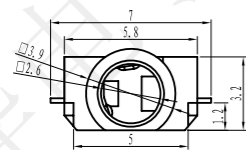

CIRCUIT DIAGRAM

序号	名称	数量	材料	表面处理
7	基座	1	PPA	黑色
6	6#触片	1	磷铜 t=0.2	镀金
5	5#触片	1	铍青铜 t=0.2	镀金
4	4#触片	1	铍青铜 t=0.2	镀金
3	3#触片	1	磷铜 t=0.2	镀金
2	2#触片	1	磷铜 t=0.2	镀金
1	1#触片	1	磷铜 t=0.2	镀金

受控文件

深圳市兴烨电子有限公司
ShenZhen XingYe Electronics co., Ltd

Series Name :
Product Name :
PJ-2.5-2065贴片沉板1.2编带

TOLERANCE		
X.X ±0.30	X.° ±2°	APPD: 陈爱光
XX ±0.20	.X.° ±1°	CHED: 施立敏
XXX ±0.10	.XX.° ±0.5°	DRAW: 马洪飞
UNITS	mm	

Part NO: PJL22049		
SCALE	SHEET	REV.
1:1	1/1	A1